



# DS MANSION



# FLOOR PLAN

# Phase- I

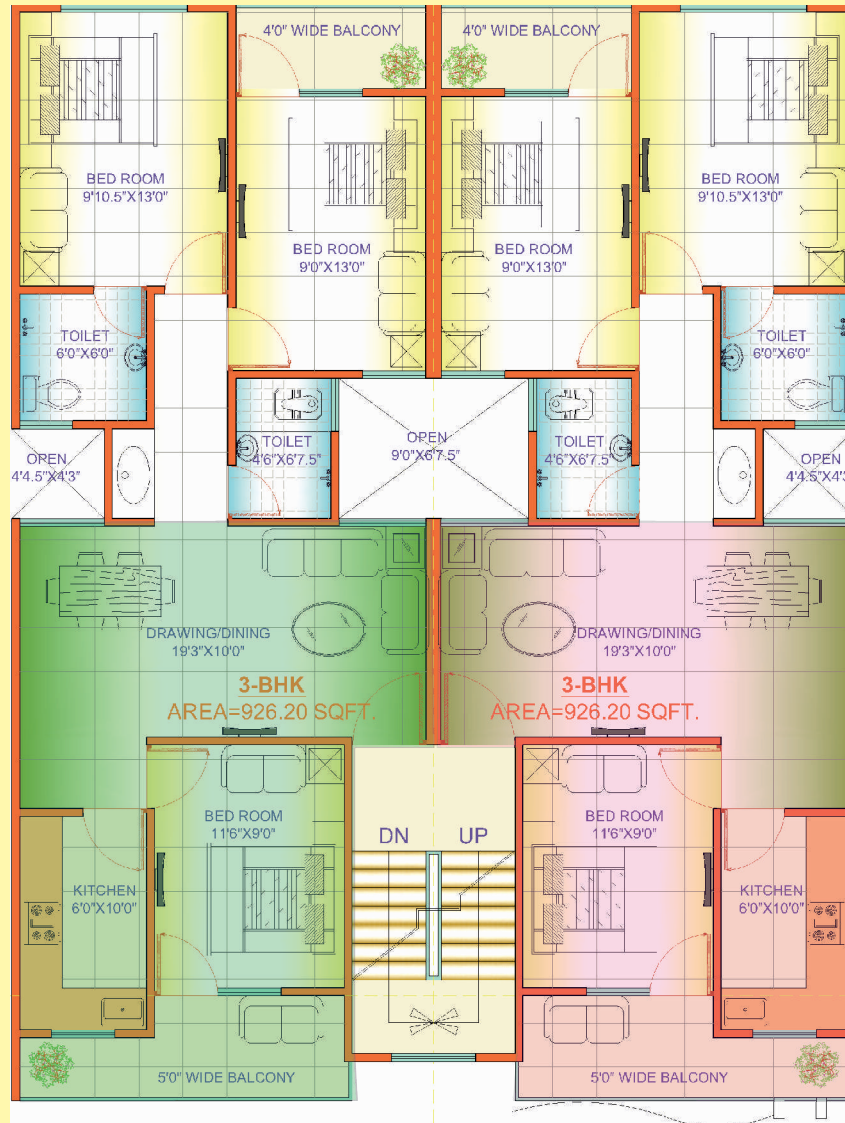

<b>3 BHK</b>	
Builtup Area	926.20
Super Builtup Area	1284.33 sq.ft

<b>3 BHK</b>	
Builtup Area	926.20 sq.ft
Super Builtup Area	1284.33 sq.ft

# FLOOR PLAN

# Phase- II & III

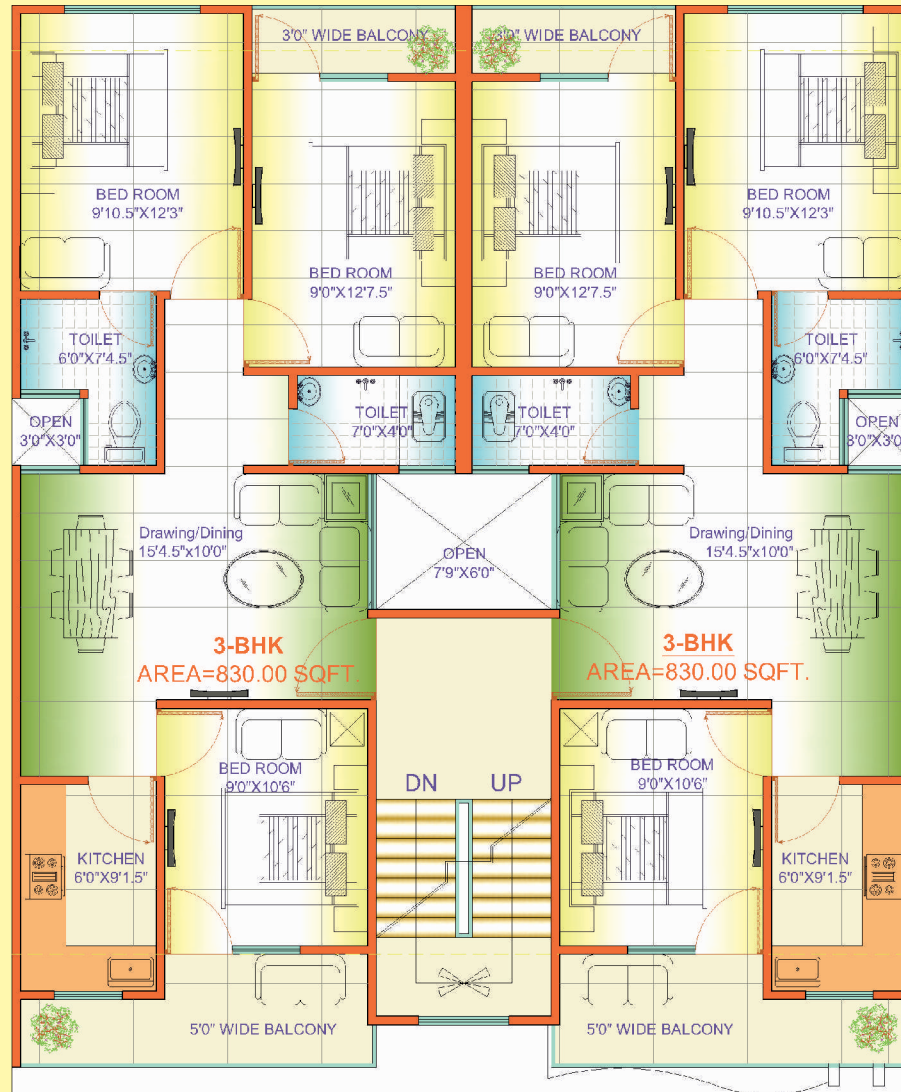

<b>3 BHK</b>	
Builtup Area	830.00 sq.ft
Super Builtup Area	1166.17 sq.ft

<b>3 BHK</b>	
Builtup Area	830.00 sq.ft
Super Builtup Area	1166.17 sq.ft

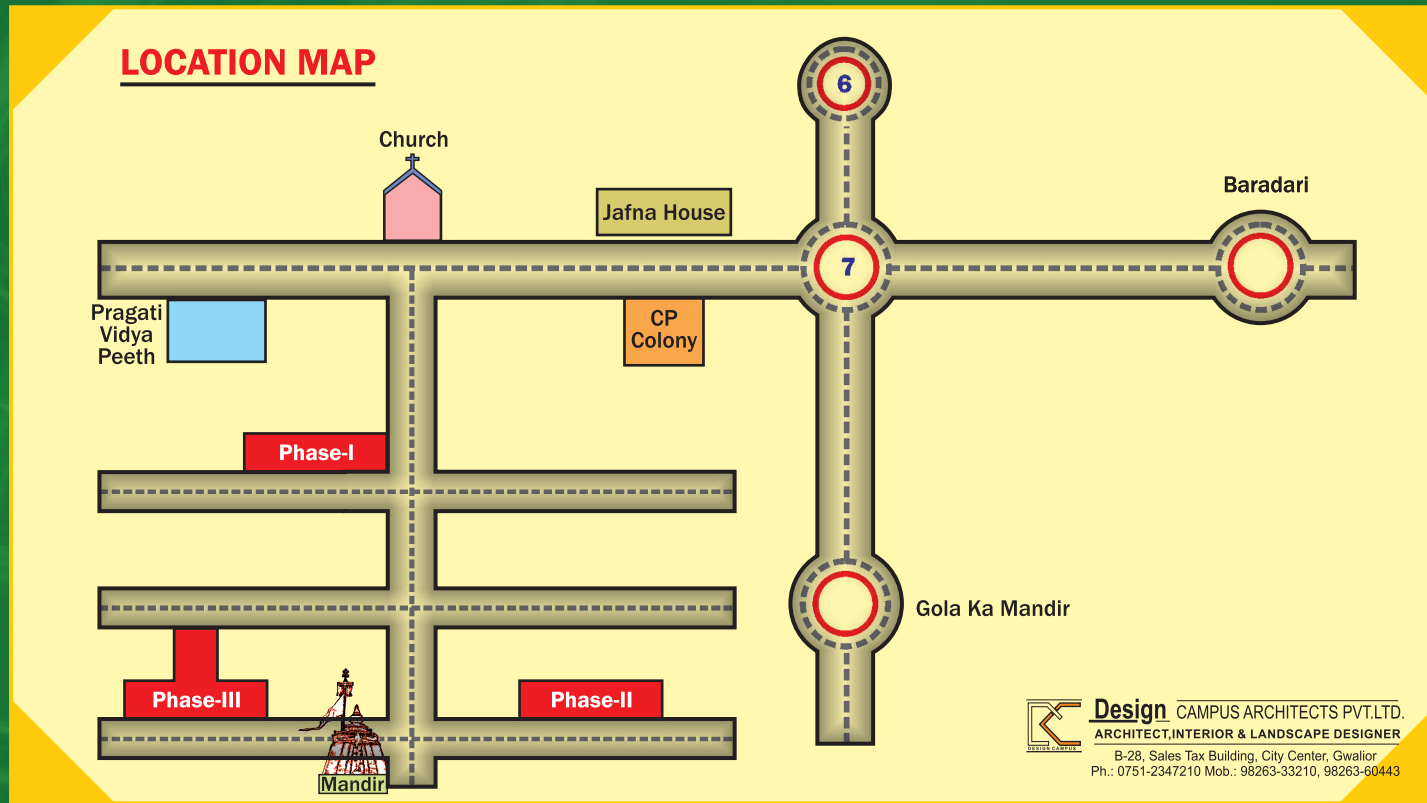

SPECIFICATION	LOCATION AREA	FLOORING	FIXTURES & FITTINGS	WALLS	EXTERNAL DOORS & WINDOWS FITTING
	Living Room Dining Room Bed Room	Vitrified Tiles with Skirting	Modular Switches/ Sockets, Telephone, Cable TV.	Oil Bound Distemper	Door frame in Salwood / Assam with flush Doors. & Window
	Toilets	Anti-Skid Tiles	Cera or Equivalent for Sanitary and Plumber or Equivalent for CP fittings.	Ceramic tiles up to 7 ft. height.	
	Kitchen	Ceramic Tiles	Green Marble counter, Stainless Steel Sink & CP fitting.	Ceramic tiles up to 2 ft. Counter	
	Stair Case	Ceramic Tiles	MS Railing	Paint/Lime Wash	
	External Facade	Kota Stone	MS Railing		
		Semi-texture Finish			
	Water Harvesting				

**Main Office:**  
**D.S. Construction**  
 Ground Floor,  
 Krishna Complex,  
 Baradari Chouraha,  
 Morar, Gwalior

**Contact No.:**  
 7389099999  
 7566633333  
 8085000000  
 8120054444  
 8120043333  
 0751- 4044000

**Branch Office:**  
**D.S. Construction**  
 1st Floor, Saksham Plaza,  
 Mayur Market, Thatipur,  
 Morar, Gwalior- 474011  
 Email: info@dsconstructiongwl.com